



Julie Fei-Fan Balzer

I've got a super cute project for you just in time for Halloween! It looks super simple, but try the project and you'll gain loads of ScanNCut skills like adjusting file size, adding files, scanning, resizing, selecting, grouping, wirelessly transferring, welding, adding text...and so much more! With ScanNCut the only limitation to your creativity is your imagination!

MATERIALS:

Brother ScanNCut Machine, Colored pieces of cardstock (orange, black, green and white)

- step 1.** To save space and maximize your time, place pieces of orange, white, green, and black cardstock (all the same weight of cardstock) onto your mat. This way you can cut all of the pieces at once.

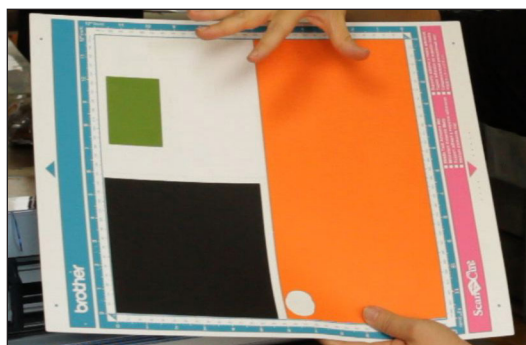

- step 2.** Go to the menu: Home > Pattern and then choose the cover image that looks like a flower and a package, and then choose the cover image that has a jack-o'-lantern and a package, and then navigate to the second page and choose the jack-o'-lantern image.

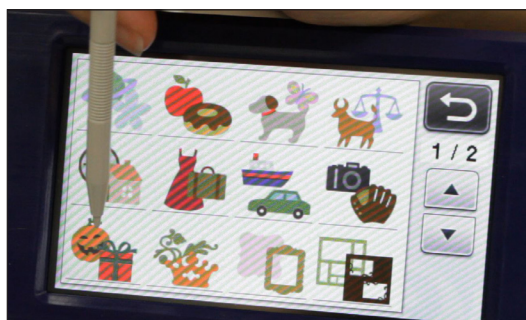

step 3. Use the plus and minus keys to adjust the size of the jack-o-lantern image to fit your needs. (Mine is 5.29" x 4.72".)

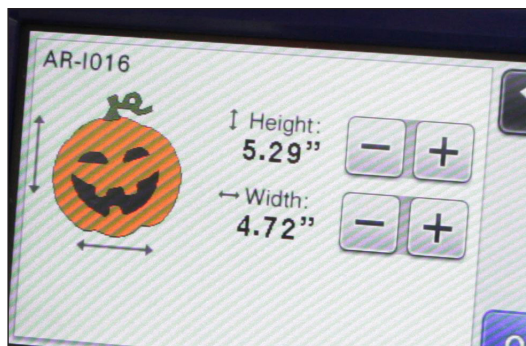

step 4. Choose the backing part (part A) and hit "OK." Then increase the number to "2" and hit "Set."

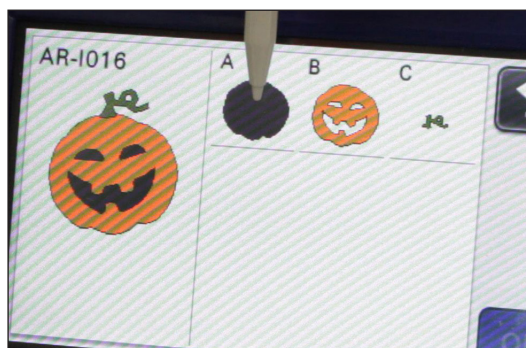

step 5. Choose "Add."

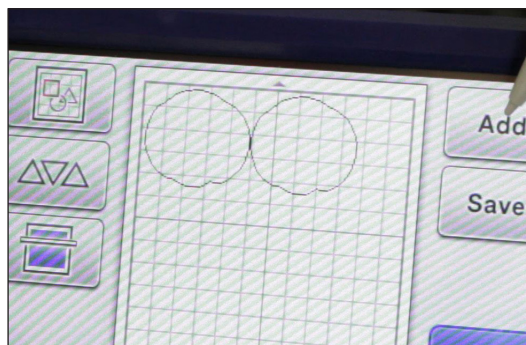

step 6. Choose the face part (part B) and hit "OK." Then flip the face using the button that looks like two triangles separated by a dotted line. Hit "Set."

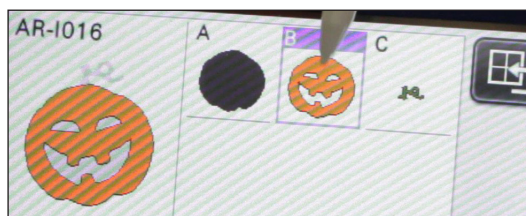

step 7. Choose "Add."

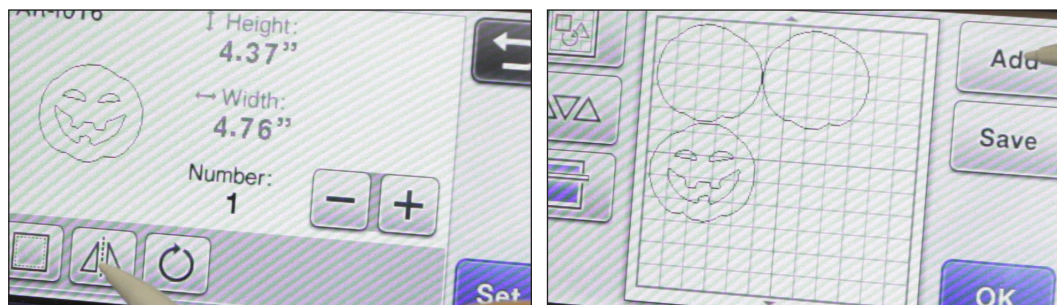

step 8. Choose the stem part (part C) and hit "OK," and then "Set."

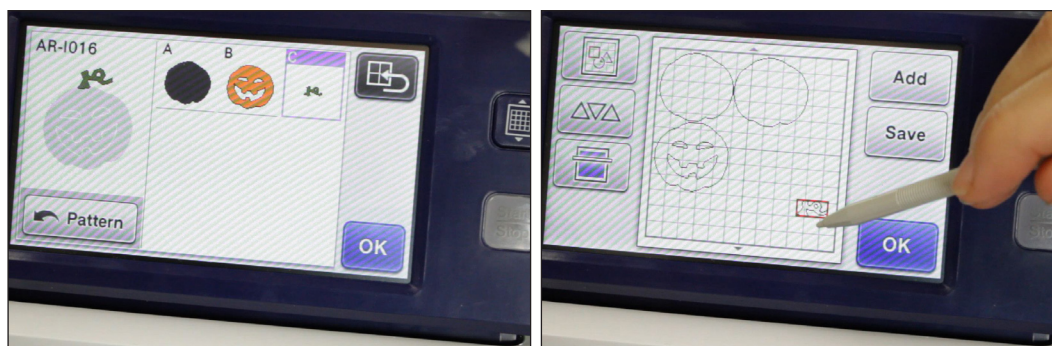

step 9. Place one of the backing parts in the extreme upper left of the screen. Place the face part so that it slightly overlaps with this backing part on the right side. This will be the main part of your card. Use the "Edging" tools if you need. (These are located under the editing functions, and look like 4 arrows).

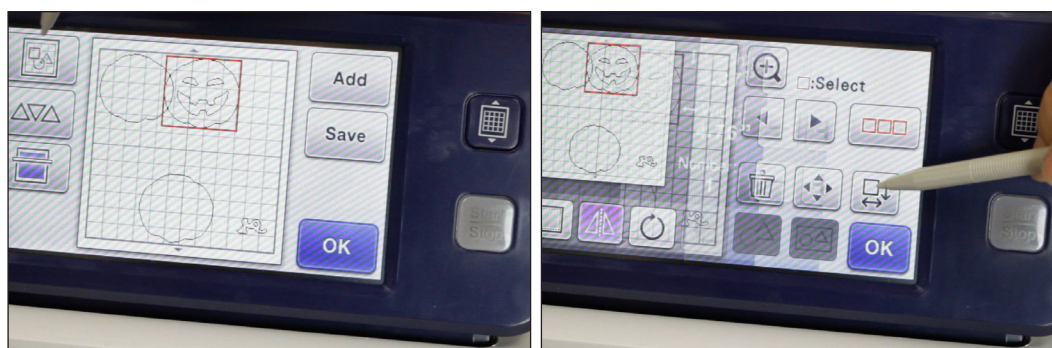

step 10. Within the editing functions, use the “Selection” tool (which looks like three red boxes) to choose the backing and face parts.

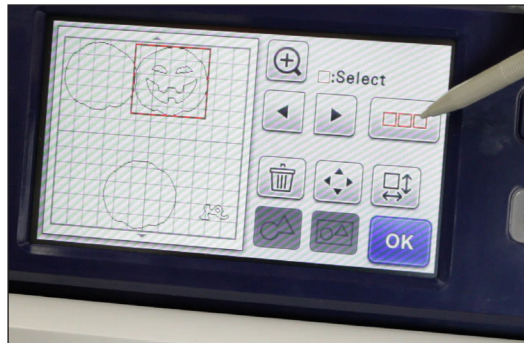

step 11. Weld the two selected parts together by hitting the “Weld” button. (This is located under the editing function and looks like a triangle and circle that are connected).

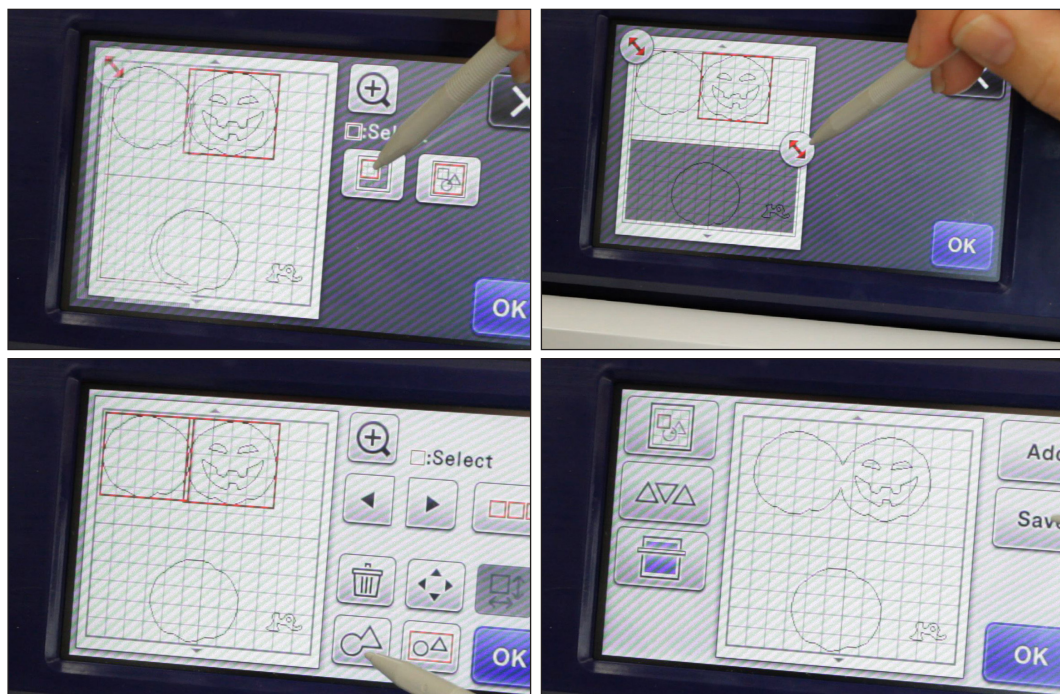

step 12. Save the file to ScanNCutCanvas wirelessly.

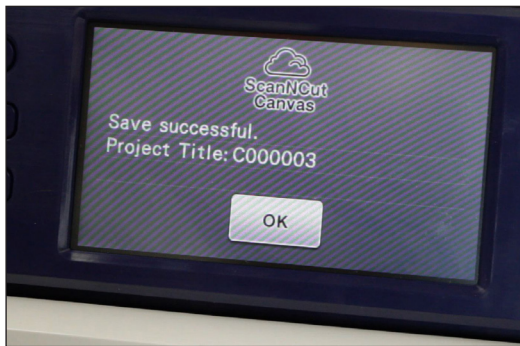
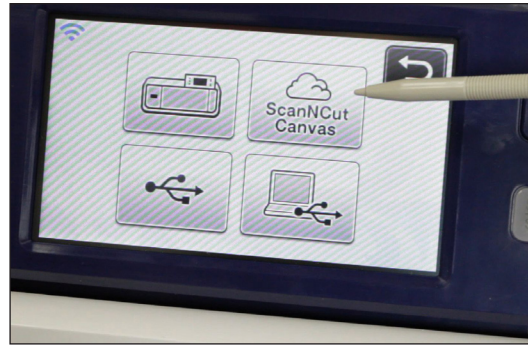
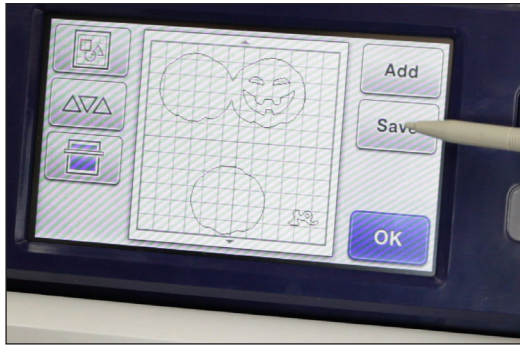

Note: ScanNCut2 models are wireless network ready.

step 13. On your tablet, open up ScanNCutCanvas online. Navigate to “My Projects” and choose to edit the file we just worked on.

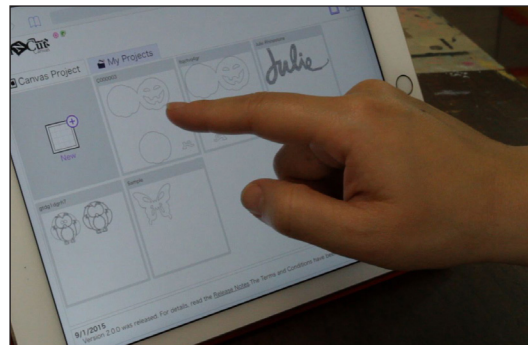
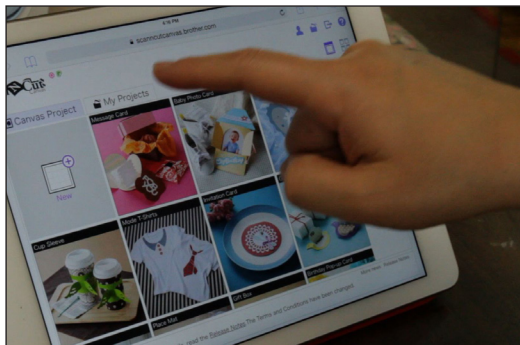

step 14. Click the arrow on the left of the screen to reveal the menu of built-in shapes and fonts. Choose the font you would like to use.

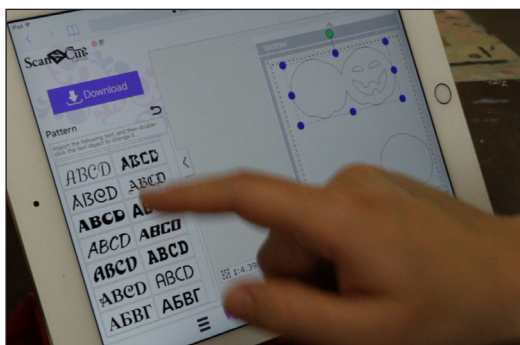

step 15. Once the placeholder text appears, double click on it and type in the text you would like to use.

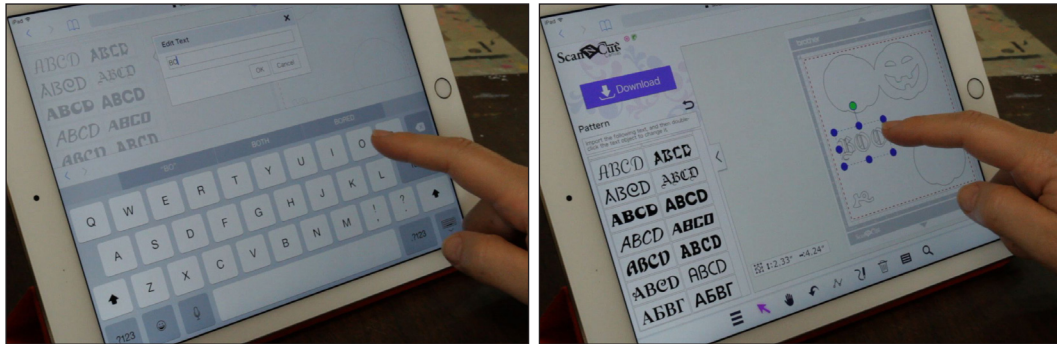

step 16. You can resize anything you'd like. (I recommend resizing the one remaining backing piece to a slightly smaller size, so that it will fit perfectly.)



step 17. Hit the “Download” button to wirelessly transfer the file back to your ScanNCut2. The option is called “ScanNCut Transfer.”

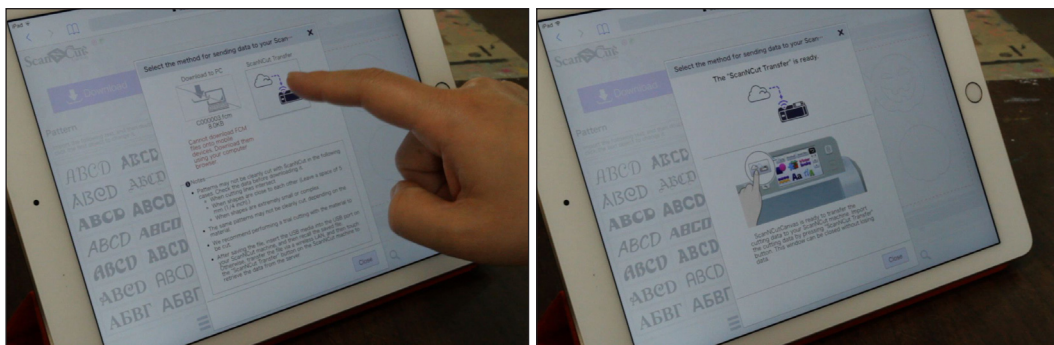

step 18. Go to the menu: Home > Pattern and then choose the icon in the upper left that looks like a cloud and a ScanNCut.



step 19. Open the dust cover, load the mat, and scan in the cardstock you've laid out using the "Scan" button. (This is located at the lower left on the screen and looks like a rectangle with a line through it.)



step 20. Once you have your scan, drag the pieces so that they will fit on the appropriately colored pieces of cardstock. Once you're satisfied, hit "OK" and then "Cut"!



step 21. Unload the mat and pull all the pieces of the pumpkin card off of the mat.



step 22. Fold the main card in half where the two pieces meet.



step 23. Glue the backing into the card. Glue the stem to the top of the jack-o-lantern face. Glue the sentiment onto the back of the card.

